

Emjoi®

BodyBare AquaSmooth

wet & dry epilator

Instruction Booklet

AP17SR

Please read these instructions carefully
and retain for future reference.



Contents

Emjoi's Safety Precautions	4
Features of your BodyBare AquaSmooth epilator	6
Using your BodyBare AquaSmooth epilator	7
Using your shaver head attachment	9
Using your exfoliation head attachment	12
Care and Cleaning	13
Help Line	14
Epilator Unit Battery Disposal	14

Important instructions – retain for future use.

تأكد من تفهم احتياطات السلامة المذكورة اعلاه

請務必理解上述的安全預防措施。

Assurez-vous que les précautions ci-dessus relatives à la sécurité sont bien comprises

Versichern Sie sich, dass die obenstehenden Sicherheitsmaßnahmen verstanden werden

Βεβαιώνετε πως οι παραπάνω προφυλάξεις ασφαλείας γίνονται κατανοητές

Pastikan bahwa tindakan-tindakan keselamatan seperti di atas dimengerti anda

Accertatevi che le suddette norme di sicurezza siano comprese a dovere

上記の注意事項をよくお読みになり、安全を御確認ください

Уверете се дека погоре споменатите мерки на претпазливост се добро разбрани

Asegúrese de que las precauciones de seguridad precedentes sean bien comprendidas

کاری بکنید کہ احتیاط‌های بالا حتماً درک بشوند

ต้องแน่ใจว่า ข้อควรระวังเรื่องความปลอดภัยข้างต้น เป็นที่เข้าใจกันดี

Yukarda belirtilen güvenlik önlemlerinin anlaşılığınızdan emin olunuz

Xin kiểm chắc rằng những biện pháp làm an toàn kể trên được hiểu rõ

Emjoi's Safety Precautions

Safety Precautions for your Emjoi BodyBare epilator

- Keep out of the reach of children.
- Do not use if the tweezers or shaver is broken or damaged.
- The appliance must only be used as described in this booklet.
- This appliance is for household use only.
- **Do not immerse the product in water or any other liquid.**
- If you suffer from any of the following conditions, please see your health care provider before using your BodyBare epilator – acne, moles, diabetes, during pregnancy, eczema, hemophilia, immune deficiency, psoriasis, varicose veins or wounds.
- Do not use this unit where it can come into contact with the scalp, clothing and shoelaces to avoid personal injury and damage to the unit.
- This product has not been designed for use on the eyebrows.
- Use only with the adaptor supplied with this appliance.
- As this is a personal care product, we recommend that it is used by one person only.

Note: Use of an epilator may cause reddening or irritation of the skin. This is a normal reaction which will quickly disappear. However if the irritation remains for more than three days, please see your health care practitioner.

Ensure that the above safety precautions are understood

We are very safety conscious when designing and manufacturing consumer products, but it is essential that the product user also exercise care when using an electrical appliance. Listed below are precautions which are essential for the safe use of an electrical appliance:

- Read carefully and save all the instructions provided with an appliance.

- Always turn the power off at the power outlet before you insert or remove a plug. Remove by grasping the plug - do not pull on the cord.
- Turn the power off and remove the plug when the appliance is not in use and before cleaning.
- Do not use your appliance with an extension cord unless this cord has been checked and tested by a qualified technician or service person.
- Always use your appliance from a power outlet of the voltage (A.C. only) marked on the appliance.
- This appliance is not intended for use by young children or infirm persons unless they have been adequately supervised by a responsible adult to ensure that they can use the appliance safely.
- Young children should be supervised to ensure that they do not play with the appliance.
- Never leave an appliance unattended while in use.
- Do not use an appliance for any purpose other than its intended use.
- Do not place an appliance on or near a hot gas flame, electric element or on a heated oven. Do not place on top of any other appliance.
- Do not let the power cord of an appliance hang over the edge of a table or bench top or touch any hot surface.
- Do not operate any electrical appliance with a damaged cord or after the appliance has been damaged in any manner. If you have any concerns regarding the performance and use of your Emjoi appliance, please contact the Sunbeam Customer Service Centre.
- For additional protection, Emjoi recommend the use of a residual current device (RCD) with a tripping current not exceeding 30mA in the electrical circuit supplying power to your appliances.
- Do not immerse the appliance in water or any other liquid unless recommended.
- **WARNING:** Do not store or use your Emjoi AquaSmooth where it can fall into a tub, sink or bath of water. Do not reach for your unit if it has fallen into water, immediately unplug it.

Ensure that the above safety precautions are understood

Features of your BodyBare AquaSmooth Epilator

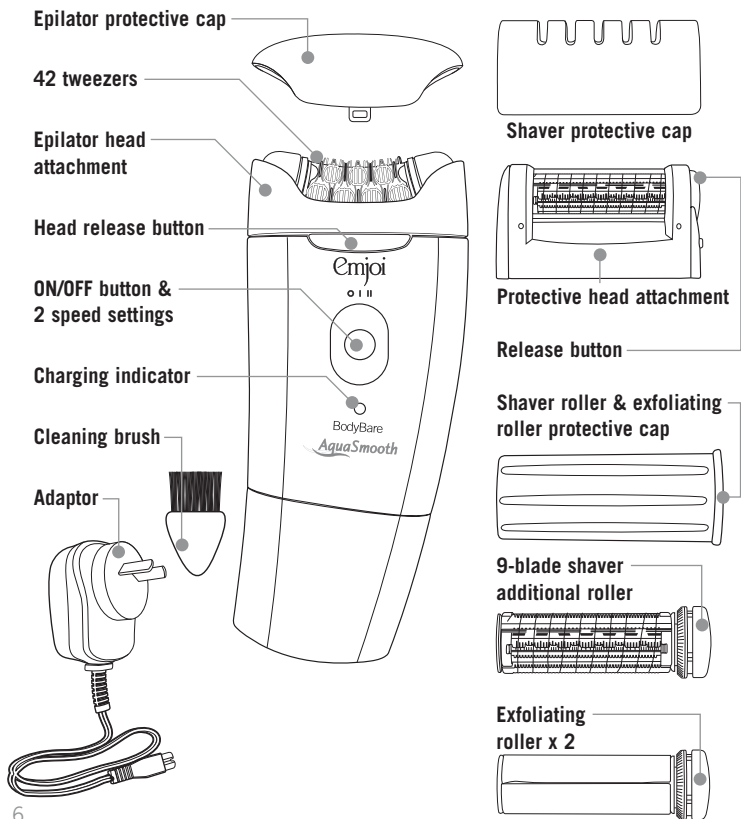

Using your BodyBare epilator

Before using your epilator for the first time

- This epilator must be fully charged before using for the first time.
- To reach optimum recharge capacity, the batteries should initially be charged for 4 hours. Do not recharge for longer than this.
- The charging indicator light will light up red to show you that the unit is charging.
- On subsequent charging, you should recharge for approximately 1 hour. The charging indicator light will change to green once the unit is fully charged. This will provide up to 40 minutes of cordless use.
- Ensure that the epilator is switched off. Insert the charging lead into the adaptor inlet, plug the adaptor into a suitable mains outlet and switch on.
- Never use the epilator corded in the shower or bath.
- To extend the life of the epilator we recommend that you fully drain the batteries every six months.

Using your Epilator

- This unit cannot be turned on or operated when the unit is plugged in with the cord in the electrical outlet. It can only be operated cordless.
- Before using your BodyBare epilator for the first time, we recommend that you familiarise yourself with how the appliance feels on the skin. Try the unit on the back of the hand before using it on delicate areas such as the face.
- If using the epilator dry, we recommend that you have a warm shower or bath before use and use a loofah or exfoliating cream to prepare the skin. Ensure that the skin is clean and dry. Do not use over body lotions or moisturisers.
- You can also use your epilator in the shower. It is recommended that you don't use it in the bath. Remove the protective cover and switch on.
- Silver Ion technology provides anti bacterial protection.
- There are two settings. Use setting I on fine hair and setting II on thicker or coarser hair. Push the speed setting button to select setting I, II or to turn unit off.
- When removing hair it is very important to hold the skin very taut to avoid pinching.
- If hair is longer than 5mm, trim with scissors before use.

Using your BodyBare epilator continued

- Hold at a 90 degree angle to the area you wish to remove hair from with the BodyBare logo facing towards you.
- Move the appliance in rapid circles, lightly gliding over the skin. There is no need to apply pressure.
- If too much pressure is applied, the appliance may slow down.
- The appliance is designed to be used on hair as short as 0.5mm so there is no need for stubble to appear before epilating.
- The appliance can be used on the legs, bikini line, underarms and face.
- The Emjoi BodyBare AquaSmooth is only intended to remove single hairs from the upper lip and chin. Hold area taut and use a small brushing motion.
- The appliance is not suitable for use on the eyebrows.

Using your shaver head attachment

- Make sure that your Emjoi AquaSmooth is in the OFF position.
- Remove the epilator head by pressing the head release button on the front of the unit.
- Attach the shaving head with the protective cap on, and press until it clicks into place.

Note: When placing the shaving head into the unit, make sure that the teethed wheel on the unit and the teethed wheel on the shaver head line up.

- Remove the protective cap and it is ready to use.

Important: The 9-blade shaver roller is made of patented razor blades. Do not touch the blades with your fingers when the unit is turned OFF or ON as it can cut your skin.

Important: You must use shaving gel or foam (not containing silicon) while using this unit. Shaving gel or foam containing silicon should not be used with Emjoi AquaSmooth as it may cause defects to the unit.

Important: Do not dry shave.

Important: Please confirm no malfunction on the 9-blade shaver roller before use. If you should find any defect on the spiral windings and blades with worn and nicked edges, please replace with a new 9-blade roller.

- Wet the areas you wish to shave with water.
- Apply shaving gel or foam to legs, bikini line or underarms. Apply only enough to cover the skin (do not use a lot of shaving foam).
- Remove the protective cover from the unit.
- To turn ON the unit, press the ON/OFF button to your desired mode.
One push - turn ON and Low mode for average growth or fine hair
Two pushes - change to High mode for heavy growth or coarse hair
- Wet the shaving head.
- Begin to shave quickly in any direction. Glide the razor over the skin, there is no need to add pressure. If you press too hard sometimes minor cuts, similar to razor cuts, may occur but will quickly disappear. We recommended shaving any direction on the underarms and bikini line and long strokes on the legs.

For best results keep continuous contact with the shaving head and your skin.

Note: The first time you use the 9-blade shaving head, the sensation you feel will be different from that of a razor blade or electric shaver. This feeling is perfectly normal and will quickly disappear once your technique for the perfect shave has been achieved.

Using your shaver head attachment continued

- If needed, rinse shaving head during your shave.
The design allows you to shave in any direction (long strokes against the grain of hair growth or circular strokes). For the smoothest results, shave against the grain.
- After shaving, press the ON/OFF button once again to turn the unit off.
- Keep the protective cap on the unit when it is not in use.

Changing The 9-Blade Shaving Roller

- Make sure the unit is turned Off before replacing the 9-blade roller.
- Please take extra care when replacing the 9-blade roller and not to touch the blades with your fingers as this can result in cutting the skin.
- The 9-blade roller contains fragile parts, please handle them with care.
- Replace the 9-blade roller when you find any defects on the roller or when you feel something scratching or worse shaving result.

Note: 9-blade rollers with worn and nicked edges could cause damage to skin.

If the spiral windings are broken, replace the new roller immediately.

Do not use the 9-blade roller if the blades or spiral windings are damaged.

1. Pull down the release button, on the side of the shaving head and the 9-blade shaving roller will pop out.
2. After the 9-blade shaving roller pops out, remove it from the shaver head attachment cylinder and dispose of it. See figure 1.
3. Remove the replacement 9-blade shaving roller from the protective cap by pressing the bottom with your pointer finger and catching it in the palm of your opposite hand. See figure 2.

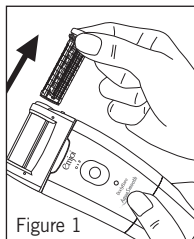

Figure 1

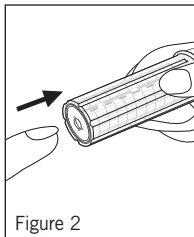

Figure 2

Using your shaver head attachment continued

4. Place a new replacement 9-blade shaving roller into the shaving head until you hear a “click” sound. Be sure to insert the new 9-blade roller into the unit with the thinner side going into the shaving head.

See figure 3.

5. After placing a new 9-blade shaving roller into the shaving head, check that it has been firmly installed with no signs of shaky or loose parts.

See figure 4.

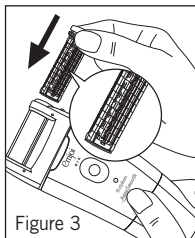

Figure 3

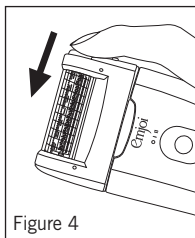

Figure 4

Using The Exfoliation Head

Important: Exfoliation rollers with worn and nicked edges could cause damage to the skin. Do not use the exfoliation roller when it is damaged or worn.

Important: Only use the exfoliation roller on your feet.

Do not use on your face or body.

- Make sure the unit is turned OFF before inserting the exfoliation roller.
- Remove the 9-blade shaving roller from the shaving head attachment and replace with the exfoliation roller. Replacing the exfoliation roller is similar to the replacement of 9-blade shaving roller, please refer to the section of

Changing the 9-blade shaving roller.

- After placing the exfoliation roller into the shaving head, check that it has been firmly installed with no signs of shaky or loose parts.
- Turn the unit ON to your desired mode, gently move the unit against your skin allowing the exfoliation roller to smooth away any dead skin.
- After exfoliation, press the ON/OFF button once again to turn the unit off.
- Keep the protective cap on your unit when it is not in use.
- Change the exfoliation roller once worn and dispose of used roller.

Care and Cleaning

Cleaning The Epilator Head

Regular cleaning and good maintenance ensures optimum results and will extend the lifetime of your Emjoi AquaSmooth.

- Do not immerse the appliance in water or any other liquid.
- Before cleaning, make sure to turn OFF your unit and if you have it plugged in, unplug it from the electrical outlet.
- Remove the disc housing from the epilator head by squeezing both sides of the disc cover and pulling up. See figure 5.
- Using the cleaning brush enclosed, remove hair on all sides of the discs.
- Alternatively you can clean the tweezers with water. Make sure to unplug your unit from the electrical outlet. Turn your unit ON and rinse the tweezers under the running tap. Turn Off your unit and gently shake to remove any moisture.
- Allow the unit to dry before replacing the disc cover and then put the protective cap on to safeguard the tweezers.
- To remove residue from the tweezers, use rubbing alcohol on the tip of the tweezers with a cotton swab that has been squeezed dry. Remove any residue alcohol before using again.

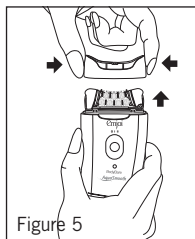

Figure 5

Note: Make sure that the cotton swab is not soaked with alcohol.

Cleaning The 9-Blade Shaving Head

- Do not store in a damp environment.
- Make sure the unit is unplugged from the adaptor before cleaning.
- Turn your unit ON.
- Rinse the 9-blade roller under the running water for 5-8 seconds.
- Turn the unit OFF and lightly shake it to remove excess moisture.
- Wipe the body of the unit with a clean dry cloth.
- Replace the protective cap.
- Any other servicing should be performed by an authorised service representative.

Help Line

If you have any additional questions about using your BodyBare epilator, please call the Sunbeam help line in Australia on 1300 881 861. In New Zealand, please call 0800 786 232

Epilator Unit Battery Disposal

- The epilator unit batteries must not be disposed of in ordinary household waste. At the end of the epilator's life, it must be returned to a Sunbeam Service Centre for correct disposal of the rechargeable battery.
 - The battery must be removed from the appliance before it is scrapped.
 - The appliance must be disconnected from the supply mains when removing the battery.
 - The battery is to be disposed of safely.
-

Emjoi Epilators and Lady Shavers are distributed in Australia and New Zealand by Sunbeam Corporation Limited. If you have any concerns regarding the performance and use of your Emjoi appliance, please contact the Sunbeam Customer Service Centre.

Backed by Sunbeam's 2 year replacement guarantee and National Service network

For more information or advice on this appliance, please contact the Sunbeam Customer Service Line

Australia 1300 881 861

New Zealand 0800 786 232

Made in China.

11/10

Notes

Consumer Hotline

Australia

1300 881 861

www.emjoi.com.au

New Zealand

0800 786 232